

THE CORPORATION OF THE CITY OF NORTH BAY

BY-LAW NO. 6-80

BEING A BY-LAW TO ADOPT AND ASSUME PART  
OF A CERTAIN STREET WITHIN THE CITY OF  
NORTH BAY AS A PUBLIC ROADWAY.

NOW, THEREFORE, THE COUNCIL OF THE CORPORATION OF THE CITY  
OF NORTH BAY HEREBY ENACTS AS FOLLOWS:

1. That various widenings of Gormanville Road - north and south of the intersection of Highway 17 in Lots 22 and 23, Concessions "B" and "C", Geographical Township of Widdifield, now in the City of North Bay, shown hatched on the sketch marked as Schedule "A" to and forming part of this by-law are hereby adopted and assumed by the City for use as a public roadway on production and registration of the appropriate Transfer from the Minister of Transportation and Communications.
2. That the realigned Johns Manville (or Nordfibre) Road from its intersection with Gormanville Road to the previously existing road and located in Lot 23, Concession "C", Geographical Township of Widdifield now in the City of North Bay, as shown hatched on the sketch marked as Schedule "B" to and forming part of this by-law are hereby adopted and assumed by the City for use as a public roadway on production and registration of the appropriate Transfer from the Minister of Transportation and Communications.

READ A FIRST TIME IN OPEN COUNCIL THIS 7TH DAY OF JANUARY, 1980.

READ A SECOND TIME IN OPEN COUNCIL THIS 21ST DAY OF JANUARY, 1980.

READ A THIRD TIME IN OPEN COUNCIL AND FINALLY ENACTED AND PASSED  
THIS 21ST DAY OF JANUARY , 1980.

  
MAYOR

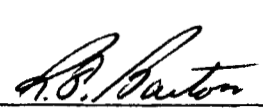
  
CITY CLERK

GEOG. TWP. OF WIDDIFIELD - CITY OF NORTH BAY

LOT 22 CON. "B" LOT 22 CON. "C"

LOT 23 CON. "B" LOT 23 CON. "C"

CONSTRUCTED UNDER  
CONTRACT 78-101  
WP No. 124-76-01  
PART OF PLATES NOS. 256-171

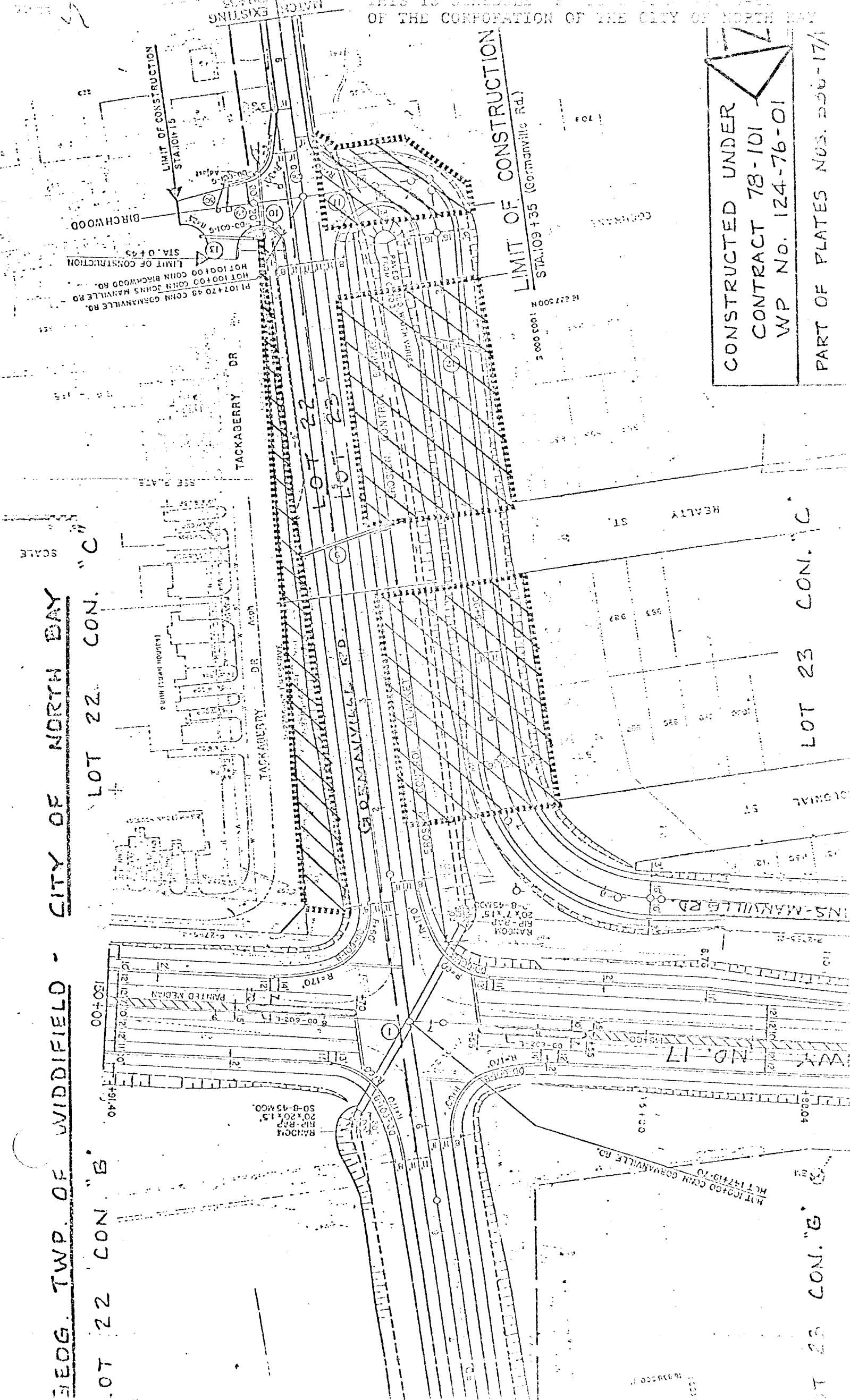

SCALE

SEE PLATE

P1 1027470 48 CORN GORMANVILLE RD.  
HOT 100400 CORN BIRCHWOOD RD.  
LIMIT OF CONSTRUCTION  
STA. 0+45

LIMIT OF CONSTRUCTION  
STA. 109+35 (Gormanville Rd.)

2 DIM (DOWN HOUSTON)

PAINTED MEDIAN

RANDOM  
R.P. 20x7x15  
50-B-45 MO.

WY. NO. 17

HOT 100400 CORN GORMANVILLE RD.  
HOT 147410-70

15+00

48004

15+00

15+00

15+00

15+00

15+00

5 000 000  
16 27 500 N

1 701

GORMANVILLE

REALTY ST

987

988

989

990

991

992

993

994

995

996

997

998

999

1000

1001

1002

1003

1004

1005

COLONIAL ST

Wm-MANNVILLE RD.

110

111

112

113

114

115

116

117

118

119

120

121

MARCH EXISTING

LIMIT OF CONSTRUCTION  
STA. 101+15

BIRCHWOOD

TACKABERRY DR

LOT 22

LOT 23

GORMANVILLE RD.

Wm-MANNVILLE RD.

Wm-MANNVILLE RD.

Wm-MANNVILLE RD.

Wm-MANNVILLE RD.

Wm-MANNVILLE RD.

Wm-MANNVILLE RD.

Wm-MANNVILLE RD.

Wm-MANNVILLE RD.

Wm-MANNVILLE RD.

Wm-MANNVILLE RD.

Wm-MANNVILLE RD.

Wm-MANNVILLE RD.

Wm-MANNVILLE RD.

Wm-MANNVILLE RD.

Wm-MANNVILLE RD.

Wm-MANNVILLE RD.

Wm-MANNVILLE RD.

Wm-MANNVILLE RD.

Wm-MANNVILLE RD.

150+00

151+00

152+00

153+00

154+00

155+00

156+00

157+00

158+00

159+00

160+00

161+00

162+00

163+00

164+00

165+00

166+00

167+00

168+00

169+00

170+00

171+00

172+00

173+00

174+00

175+00

176+00

177+00

178+00

179+00

180+00

181+00

182+00

183+00

184+00

185+00

186+00

187+00

188+00

189+00

190+00

191+00

192+00

193+00

194+00

195+00

196+00

197+00

198+00

199+00

200+00

201+00

202+00

203+00

204+00

205+00

206+00

207+00

208+00

209+00

210+00

211+00

212+00

213+00

214+00

215+00

216+00

217+00

218+00

219+00

220+00

221+00

222+00

223+00

224+00

225+00

226+00

227+00

228+00

229+00

230+00

231+00

232+00

233+00

234+00

235+00

236+00

237+00

238+00

239+00

240+00

241+00

242+00

243+00

244+00

245+00

246+00

247+00

248+00

249+00

250+00

251+00

252+00

253+00

254+00

255+00

256+00

257+00

258+00

259+00

260+00

261+00

262+00

263+00

264+00

265+00

266+00

267+00

268+00

269+00

270+00

271+00

272+00

273+00

274+00

275+00

276+00

277+00

278+00

279+00

280+00

281+00

282+00

283+00

284+00

285+00

286+00

287+00

288+00

289+00

290+00

291+00

292+00

293+00

294+00

295+00

296+00

297+00

298+00

299+00

300+00

301+00

302+00

303+00

304+00

305+00

306+00

307+00

308+00

309+00

310+00

311+00

312+00

313+00

314+00

315+00

316+00

317+00

318+00

319+00

320+00

321+00

322+00

323+00

324+00

325+00

326+00

327+00

328+00

329+00

330+00

331+00

332+00

333+00

334+00

335+00

336+00

337+00

338+00

339+00

340+00

341+00

342+00

343+00

344+00

345+00

346+00

347+00

348+00

349+00

350+00

351+00

352+00

353+00

354+00

355+00

356+00

357+00

358+00

359+00

360+00

361+00

362+00

363+00

364+00

365+00

366+00

367+00

368+00

THIS IS SCHEDULE 'A' TO B.L. NO. 6-80 OF THE CORPORATION OF THE CITY OF NORTH BAY

MTC GARAGE AND OPERATIONS COMPLEX

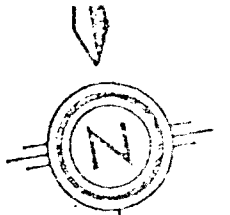

LIMIT OF CONSTRUCTION STA. 88+00

PROPOSED TRANSFER  
GEOG. TWP. OF WIDDIFIELD

DISTRICT OF NIPISSING

H.O.T. 100+41.16 McKEOWN AVE.  
H.O.T. 92+75.00 GORMANVILLE RD.

LIMIT OF CONSTRUCTION STA. 100+82.16

GORMANVILLE ROAD  
CITY OF NORTH BAY

LOT 23 CON "B"

LOT 22 CON "B"

