



R 75752

Ontario Municipal Board

IN THE MATTER OF Section 35  
of The Planning Act (R.S.O.  
1970, c. 349),

- and -

IN THE MATTER OF an application  
by The Corporation of the City  
of North Bay for approval of  
its Restricted Area By-law 26-75

B E F O R E :

A. H. ARRELL, Q.C.,  
Vice-Chairman

-and-

A. B. BALL,  
Member

}  
} Wednesday, the 16th day of  
} July, 1975  
}

No objections to approval having been received as  
required;

THE BOARD ORDERS that By-law 26-75 is hereby approved.

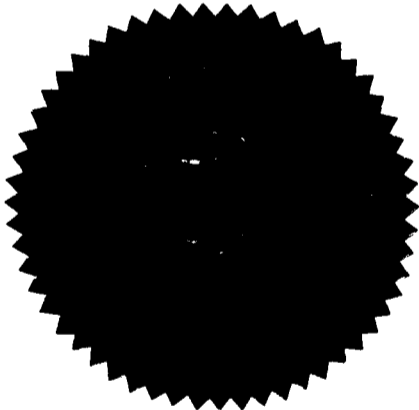

*C. Saruyama*  
C. SARUYAMA  
ACTING SECRETARY

ENTERED  
O. B. No. *R 75-2*  
Folio No. *203*  
JUL 18 1975  
*[Signature]*  
SECRETARY, ONTARIO MUNICIPAL BOARD

CITY OF NORTH BAY  
**RECEIVED**  
JUL 21 1975

THE CORPORATION OF THE CITY OF NORTH BAY

BY-LAW NO. 26-75

BEING A BY-LAW TO AMEND BY-LAW NO. 9-69  
OF THE CITY OF NORTH BAY PURSUANT TO  
SECTION 35 OF THE PLANNING ACT, R.S.O.  
1970, CHAPTER 349, AND AMENDMENTS THERETO.

WHEREAS upon the request of the property owner  
concerned and with the approval of the local Planning Board it  
is considered advisable to amend By-law No. 9-69 of the City  
of North Bay to provide for an alteration to the zone designa-  
tion shown on Schedule "A" which forms part of said By-law No.  
9-69;

NOW THEREFORE THE COUNCIL OF THE CORPORATION OF THE CITY OF  
NORTH BAY HEREBY ENACTS AS FOLLOWS:

1. Schedule "A" of By-law No. 9-69 of the City of North Bay is amended by changing the zoning designation of the land shown on that part of said zoning map set out in Schedule "A" attached hereto and forming part thereof, which property is more particularly described as Lots 410, 411, 412, 413, 414, 415, 416 and 417 Plan 93 and the lane parallel to the south property line of Lot 415 Plan 93 shown as hatched on Schedule "B" attached hereto and forming part thereof from Residential Multiple Second Density Zone (RM2) to a Residential Multiple Third Density Zone (RM3).
2. This By-law shall take effect from the date of passing by Council and shall come into force upon the approval of the Ontario Municipal Board.

READ A FIRST TIME IN OPEN COUNCIL THIS 24TH DAY OF FEBRUARY, 1975.

READ A SECOND TIME IN OPEN COUNCIL THIS 10TH DAY OF MARCH, 1975.

READ A THIRD TIME IN OPEN COUNCIL AND FINALLY ENACTED AND PASSED THIS 10TH DAY OF MARCH, 1975.

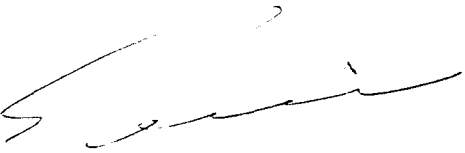
.....  
  
 MAYOR

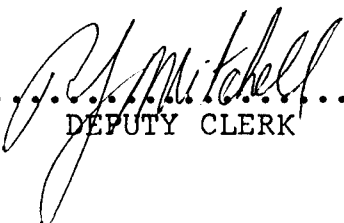
.....  
  
 DEPUTY CLERK

- RESIDENTIAL FIRST DENSITY ZONE
- RESIDENTIAL SECOND DENSITY ZONE
- RESIDENTIAL THIRD DENSITY ZONE
- RESIDENTIAL MULTIPLE FIRST DENSITY ZONE
- RESIDENTIAL MULTIPLE SECOND DENSITY ZONE
- RESIDENTIAL MULTIPLE THIRD DENSITY ZONE
- RESIDENTIAL MULTIPLE FOURTH DENSITY ZONE
- RESIDENTIAL MULTIPLE FIFTH DENSITY ZONE
- RESIDENTIAL MULTIPLE SIXTH DENSITY ZONE

- GENERAL COMMERCIAL ZONE
- NC N'HOOD COMMERCIAL ZONE
- HC HIGHWAY COMMERCIAL ZONE
- DC DISTRICT COMMERCIAL ZONE
- I-C1 INDUSTRIAL CLASS 1 ZONE
- I-C2 INDUSTRIAL CLASS 2 ZONE
- I-C3 RAILWAY ZONE
- O OPEN SPACE ZONE
- RU RURAL ZONE

RM3



SCHEDULE A  
LAKE NIPISSING

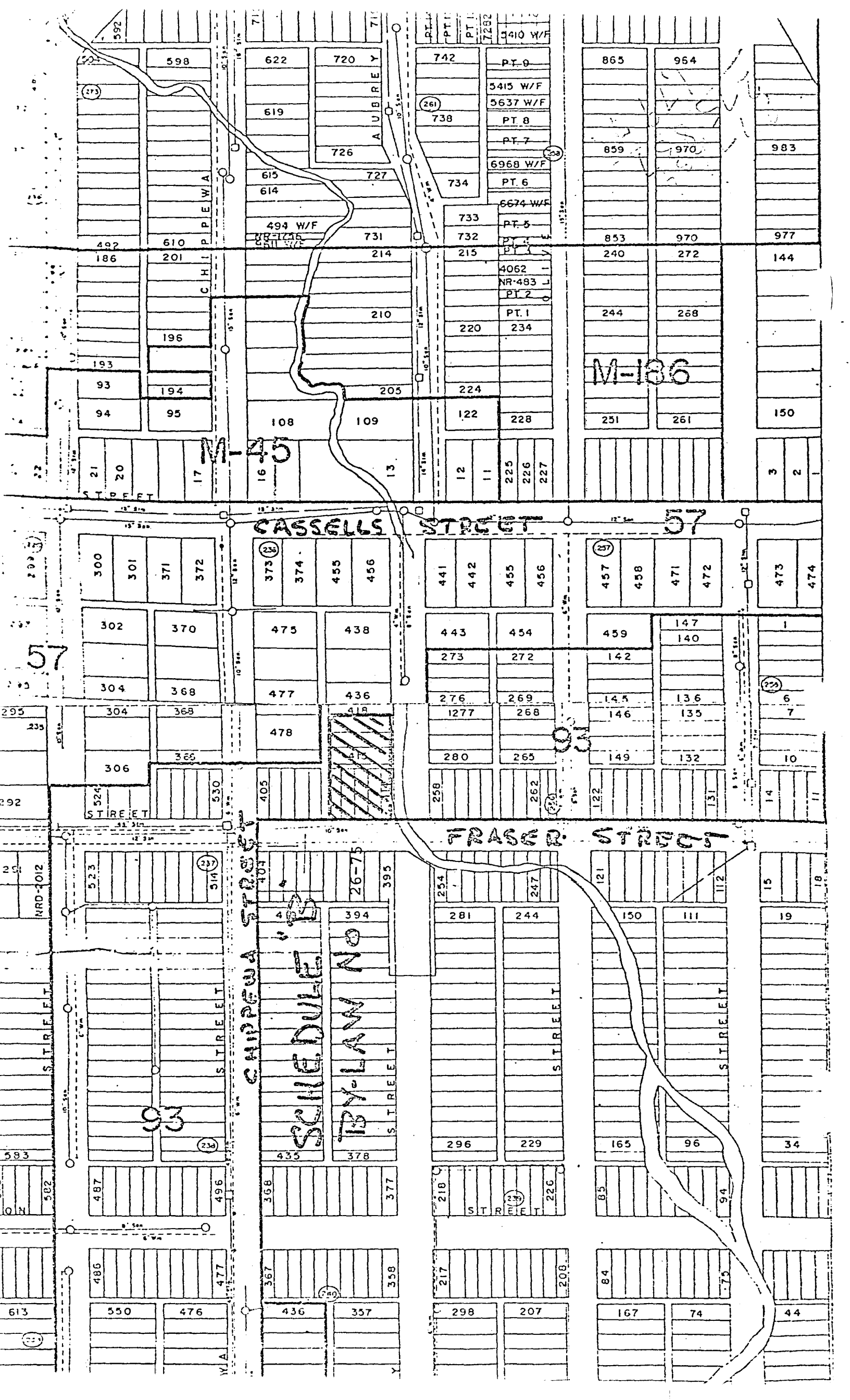

CASSELLS STREET

FRASER STREET

CHIPPEWA STREET

SCHEDULE 'B'  
BY-LAW No 26-75

M-186

M-45

CHIPPewa

AUBREY

598  
592

622  
720  
619  
726  
615  
727  
614

742  
PT. 9  
5415 W/F  
5637 W/F  
738  
PT. 8  
PT. 7  
6968 W/F  
734  
PT. 6  
6674 W/F  
733  
PT. 5  
732  
PT. 4  
4062  
NR-483 L  
PT. 2  
PT. 1  
220  
234  
224  
122  
228

865  
954  
859  
970

983  
977  
144  
150

497  
186  
201  
196  
193  
93  
194  
94  
95

494 W/F  
731  
214  
210  
205  
108  
109

215  
225  
226  
227

853  
240  
244  
251

970  
272  
268  
261

21  
20  
17

16  
13

12  
11

251  
261

3  
2  
1

57

57

57

300  
301  
371  
372

373  
374  
455  
456

441  
442  
455  
456

457  
458  
471  
472

473  
474

302  
370

475  
438

443  
454

459  
147  
140

1

304  
368

477  
436

273  
272  
276  
269  
1277  
268

142  
145  
136  
146  
135

6  
7

306  
366

478  
418

280  
265  
258  
262

149  
132

10  
14  
11

524  
530

405

254  
247

121  
112

15  
18

523  
514

394

281  
244

150  
111

19

487  
496

435  
378

296  
229

165  
96

34

485  
477

368  
377

218  
226

85  
94

15  
18

486  
476

367  
358

217  
208

84  
75

15  
18

613  
550  
476

436  
357

298  
207

167  
74

44

485  
477

367  
358

217  
208

84  
75

15  
18

613  
550  
476

436  
357

298  
207

167  
74

44